



2 BEDROOM 2 BATH 1,074 SF

APT 507



\$ _____ \$ _____ \$ _____ \$ _____
MONTHLY RENT DEPOSIT PROCESSING FEE MOVE-IN TOTAL

NOTES _____

Square footage is calculated using the ANSI/BOMA Z65.4-2010 net method standard for home measurement. All plans, pricing, and specifications are subject to revisions deemed advisable by builder or architect, or required by law.

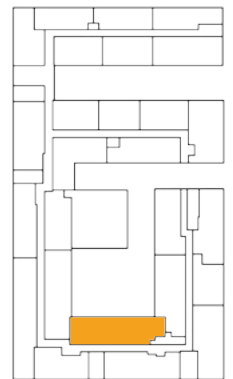

 E PLEASANT ST

