



1 BEDROOM 1 BATH 650 SF

APT 403



\$ _____ MONTHLY RENT
 \$ _____ DEPOSIT
 \$ _____ PROCESSING FEE
 \$ _____ MOVE-IN TOTAL

NOTES _____

Square footage is calculated using the ANSI/BOMA Z65.4-2010 net method standard for home measurement. All plans, pricing, and specifications are subject to revisions deemed advisable by builder or architect, or required by law.

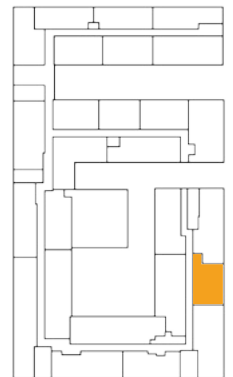

 E PLEASANT ST

