



2 BEDROOM 1 BATH 979 SF

# APT 325



\$ \_\_\_\_\_  
MONTHLY RENT

\$ \_\_\_\_\_  
DEPOSIT

\$ \_\_\_\_\_  
PROCESSING FEE

\$ \_\_\_\_\_  
MOVE-IN TOTAL

NOTES \_\_\_\_\_  
\_\_\_\_\_  
\_\_\_\_\_

*Square footage is calculated using the ANSI/BOMA Z65.4-2010 net method standard for home measurement. All plans, pricing, and specifications are subject to revisions deemed advisable by builder or architect, or required by law.*

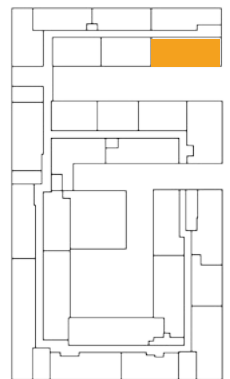

 E PLEASANT ST

